

OPERATION

The Ruelco FV-1 is a multi-function control valve. It is designed to remove the hydraulic signal to a surface controlled subsurface safety valve in the event of a fire and stop any well fluid returns due to packing leaks in the SCSSV. The FV-1 also acts as B.O.P. and provides protection from well fluid returns through the control line during normal operating conditions. The FV-1 operates as a fire safety and its operation as B.O.P. are completely independent of each other. When a fire activates the FV-1, it blocks and bleeds the hydraulic pressure going to SCSSV allowing it to close. After a fixed elapsed time the FV-1 will close off any further returns from the SCSSV. When operating as B.O.P. the FV-1 will allow returns from the hydraulic control line for the same elapsed time as if exposed to a fire and then it will block any further flow from the SCSSV, thus minimizing any well fluids from flowing back to the hydraulic control system.

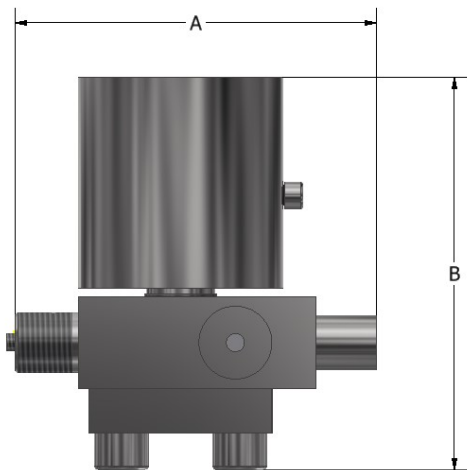

FEATURES

- Rugged and compact design
- Stainless steel construction
- B.O.P. function prevents hazards due to SCSSV packing leaks under normal and fire operating conditions
- Block and bleed operation closes SCSSV automatically under fire conditions
- Metal to metal valve seats
- B.O.P. function independent of fire activated operation
- Field repairable



DIMENSIONS

A	5.00" (127 mm)
B	5.60" (142.2 mm)
C	2.80" (71.1 mm)
OUTLET PORT	1/2" MNPT
INLET PORT	1/4" FNPT
WEIGHT	7.1 LBS (3.2 KG)

PHONE: 504-340-0055
FAX: 504-340-0056
EMAIL: SALES@RUELCO.COM

1209 DISTRIBUTORS ROW
NEW ORLEANS, LA 70123

FV-1 FIRE SAFETY VALVE

PARTS LIST

ITEM	QUANTITY	DESCRIPTION	MATERIAL
1	1	TIMER BODY CAP	316 ST. STL.
2	1	TIMER BODY	17-4 PH ST. STL.
3*	1	TIMER BODY CAP SEAL	FLUOROCARBON
4	2	TIMER SPRING	INCONEL X-750
5	1	FLOW CONTROL SPRING	INCONEL X-750
6	1	FLOW CONTROL STEM	316 ST. STL.
7*	1	FLOW CONTROL SEAL	FLUOROCARBON
8*	1	TIMER SPOOL MIDDLE BACKUP	TEFLON
9*	1	TIMER SPOOL MIDDLE SEAL	FLUOROCARBON
10	1	SPRING GUIDE LOCK SCREW	316 ST. STL.
11	1	SHUT OFF VALVE SPRING GUIDE	INCONEL X-750
12	1	SHUT OFF VALVE SPRING	316 ST. STL.
13	1	SHUT OFF VALVE POPPET	316 ST. STL.
14	2	CROSSOVER PLATE BOLT	316 ST. STL.
15*	1	CROSSOVER PLATE SEAL	FLUOROCARBON
16*	1	TIMER SPOOL LOWER SEAL	FLUOROCARBON
17	1	CROSSOVER PLATE	316 ST. STL.
18*	1	TIMER SPOOL UPPER SEAL	FLUOROCARBON
19*	1	TIMER SPOOL UPPER SEAL	TEFLON
20	1	TIMER ORIFICE	316 ST. STL.
21*	1	TIMER ORIFICE SEAL	FLUOROCARBON
22	1	OIL FILL PORT SCREW	316 ST. STL.
23*	1	OIL FILL PORT SEAL	FLUOROCARBON
24*	1	TIMER SPOOL OIL SEAL	TEFLON
25	1	TIMER SPOOL	316 ST. STL.
26	1	INLET FITTING	17-4 PH ST. STL.
27*	1	INLET FITTING SEAL	FLUOROCARBON
28	1	BODY	316 ST. STL.
29	1	BLOCK AND BLEED VALVE POPPET	316 ST. STL.

FV-1 FIRE SAFETY VALVE

PHONE: 504-340-0055
 FAX: 504-340-0056

1209 DISTRIBUTORS ROW
 NEW ORLEANS, LA 70123

PARTS CONT.

30*	1	TIMER BODY SEAL	FLUOROCARBON
31	1	BLOCK AND BLEED EUTECTIC PLUG	EUTECTIC
32	1	BLOCK AND BLEED CAP	316 ST. STL.
33	1	BLOCK AND BLEED PISTON	316 ST. STL.
34	1	BLOCK AND BLEED STEM	17-4 PH ST. STL.
35*	1	BLOCK AND BLEED STEM UPPER BACKUP	TEFLON
36*	1	BLOCK AND BLEED STEM UPPER SEAL	FLUOROCARBON
37*	1	BLOCK AND BLEED STEM LOWER BACKUP	TEFLON
38*	1	BLOCK AND BLEED STEM LOWER SEAL	FLUOROCARBON
39	1	LOCK OPEN EUTECTIC	EUTECTIC
40*	4 OZ.	TIMER OIL	PETROLEUM BASE
41	1	ADJUSTMENT NUT	316 ST. STL.

* INDICATES ITEMS IN THE REPAIR KIT

SPECIFICATIONS

MAXIMUM WORKING PRESSURE	10,000 PSI (690 BAR)
MINIMUM WORKING PRESSURE	1,000 PSI (69 BAR)
B.O.P. RESPONSE TIME	6 MIN @ 72°F (22°C) 1 MIN @ 300° (149°C)
AMBIENT OPERATING TEMPERATURE RANGE	-20° to 250°F -29° to 121°C
Cv NORMAL OPERATION	.063
Cv FIRE ACTIVATED	.097

REPAIR KIT

- 2V-018-000

OTHER TEMPERATURE RANGES
AND SEAL COMPOUNDS AVAILABLE
UPON REQUEST

ORDERING CODE

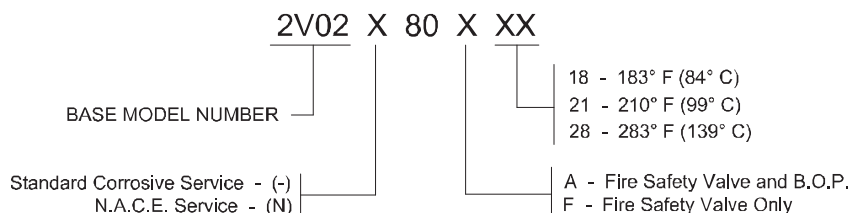

PHONE: 504-340-0055
FAX: 504-340-0056
EMAIL: SALES@RUELCO.COM

1209 DISTRIBUTORS ROW
NEW ORLEANS, LA 70123

FV-1 FIRE SAFETY VALVE